



University of Jamestown Athletic Second Addition Replat of Portions of Blocks 6, 7 and 9 of Jamestown College Subdivision, and Lot 2, Block 1 of University of Jamestown Athletic Addition Within the NE1/4 of Section 25, T140N, R64W Jamestown, North Dakota

DECLARATION

The parties set forth herein as Owners and Proprietors of the land hereinafter described, together with Daren Peterka, Interstate Engineering, Inc., a Registered Land Surveyor in the State of North Dakota, hereby declare and make known that said Owners and Proprietors recently caused to be plotted a tract of land within Blocks 6, 7 and 9 of Jamestown College Subdivision, and Lot 2, Block 1 of University of Jamestown Athletic Addition, being within the northeast quarter of Section 25, T140N, R64W of the Fifth Principal Meridian, being within the City of Jamestown, Midway Township, Stutsman County, North Dakota hereinafter known as "University of Jamestown Athletic Second Addition". The plat thereof which is hereby shown was made by said Daren Peterka, in accordance with the statutes of the State of North Dakota and the ordinances of the City of Jamestown, North Dakota, in such case, made and provided a description of the situation and boundaries of said plat being as follows:

EXISTING PLAT BOUNDARY DESCRIPTION

A tract of land located within Blocks 6, 7 and 9 of Jamestown College Subdivision, and Lot 2, Block 1 of University of Jamestown Athletic Addition, being within the northeast quarter of Section 25, T140N, R64W of the Fifth Principal Meridian, being within the City of Jamestown, Midway Township, Stutsman County, North Dakota more particularly described as follows:
 Commencing at the east corner of said Section 25; thence S89°51'29"W along the quarter line of said lot of said Section 25 a distance of 363.41 feet; thence N00°00'00"E a distance of 52.88 feet to the Point of Beginning [POB (Addition)]; thence N89°58'46"W a distance of 404.44 feet to a point on the east boundary of Block 7 of Jamestown College Subdivision (Document No. X111222, recorded January 22, 1992), thence continuing N89°58'46"W a distance of 18.15 feet; thence N00°23'50"E a distance of 56.70 feet to a point on the north boundary of Block 7 of Jamestown College Subdivision (Document No. X111222, recorded January 22, 1992), thence continuing N00°23'50"E a distance of 74.30 feet to point on the south boundary of Lot 2, Block 1 of University of Jamestown Athletic Addition (Document No. 0230358, recorded November 25, 2019); thence continuing N00°23'50"E a distance of 159.00 feet to a point on the south boundary of Lot 1, Block 1 of University of Jamestown Athletic Addition (Document No. 0230358, recorded November 25, 2019); thence S89°58'46"E along the south boundary of Lot 1, Block 1 of University of Jamestown Athletic Addition (Document No. 0230358, recorded November 25, 2019) a distance of 416.00 feet to the northeast corner of Lot 2, Block 1 of University of Jamestown Athletic Addition (Document No. 0230358, recorded November 25, 2019); thence continuing S89°58'46"E along the south boundary of Lot 1, Block 1 of University of Jamestown Athletic Addition (Document No. 0230358, recorded November 25, 2019) a distance of 299.00 feet to the point of beginning.
 Said tract of land contains 2.82 acres or 122,667 square feet, more or less.

INGRESS/EGRESS EASEMENT DESCRIPTION

A strip of land located within Block 6 of Jamestown College Subdivision and Lot 1, Block 1 of University of Jamestown Athletic Addition, being within the northeast quarter of Section 25, T140N, R64W of the Fifth Principal Meridian, being within the City of Jamestown, Midway Township, Stutsman County, North Dakota, being 30.00 feet in width, the east boundary being 15.00 feet east and parallel to the following described survey centerline and the west boundary being 15.00 feet west and parallel to the following described survey centerline:
 Commencing at the northeast corner of Lot 1, Block 1 of University of Jamestown Athletic Addition (Document No. 0230358, recorded November 25, 2019); thence S89°47'50"W along the north boundary of Lot 1, Block 1 of University of Jamestown Athletic Addition (Document No. 0230358, recorded November 25, 2019) a distance of 156.39 feet to the Point of Beginning [POB (Easement)]; thence S00°23'50"W a distance of 259.22 feet; thence N89°58'46"W a distance of 6.00 feet to a point on the east boundary of Lot 2, Block 1 of University of Jamestown Athletic Addition (Document No. 0230358, recorded November 25, 2019), also being the point of ending [POE (Easement)].
 The east boundary of said strip is intended to be lengthened or shortened to begin at the north boundary of Lot 1, Block 1 of University of Jamestown Athletic Addition (Document No. 0230358, recorded November 25, 2019) and terminate at the east boundary of Lot 2, Block 1 of University of Jamestown Athletic Addition (Document No. 0230358, recorded November 25, 2019); the east boundary of the segment of said strip are intended to be extended to the intersection, and the west boundary of said strip is intended to be lengthened or shortened to begin at the north boundary of Lot 1, Block 1 of University of Jamestown Athletic Addition (Document No. 0230358, recorded November 25, 2019) and terminate at the northeast corner of Lot 2, Block 1 of University of Jamestown Athletic Addition (Document No. 0230358, recorded November 25, 2019) and terminate at the northeast corner of Lot 2, Block 1 of University of Jamestown Athletic Addition (Document No. 0230358, recorded November 25, 2019).
 Said strip of land contains 0.18 acres or 8,017 square feet, more or less.

NEW DESCRIPTION

Lot 1, Block 1 of University of Jamestown Athletic Second Addition, within the northeast quarter of Section 25, T140N, R64W of the Fifth Principal Meridian, being within the City of Jamestown, Midway Township, Stutsman County, North Dakota.

SURVEYOR'S CERTIFICATE

I, Daren Peterka, Interstate Engineering, Inc., a Registered Land Surveyor in the State of North Dakota, do hereby certify that this plat is a true and correct representation of the survey of "University of Jamestown Athletic Second Addition", within the northeast quarter of Section 25, T140N, R64W of the Fifth Principal Meridian, being within the City of Jamestown, Midway Township, Stutsman County, North Dakota as surveyed by me or under my direct supervision and that all distances are correct, the monuments are in place and shown on the plat and the outside boundary lines are correctly designated as shown on the plat in accordance with the statutes of the State of North Dakota and the ordinances of the City of Jamestown to the best of my knowledge and belief.

In witness whereof I have hereunto set my hand this 20 day of March, 2023, A.D.

State of North Dakota)
 County of Stutsman)
 On this 20 day of March, 2023, A.D. before me, a Notary Public in said County and State, personally appeared Daren Peterka, known to me to be the same person described herein and who executed the within and foregoing instrument and he acknowledged to me that he executed the same.
 DENISE MCCLLEAN
 Notary Public
 State of North Dakota
 My Commission Expires November 22, 2025

CITY OF JAMESTOWN'S CERTIFICATE OF APPROVAL

State of North Dakota)
 City of Jamestown)
 By a resolution duly passed by the City Council of Jamestown, North Dakota on the 20 day of March, 2023, A.D., the shown plat of the "University of Jamestown Athletic Second Addition", within the northeast quarter of Section 25, T140N, R64W of the Fifth Principal Meridian, being within the City of Jamestown, Midway Township, Stutsman County, North Dakota was duly approved and accepted, the dedicated easement as shown for dedication, the vacation of portions of lots and blocks and the plat thereof ordered to be filed in the office of the County Recorder of Stutsman County and a copy of the same to be filed in the office of the City Auditor and the office of the City Engineer.

Dated 3/20/23
 [Signature] Daren Peterka
 Sarah Helleman, City Administrator
 Dwayne Heinrich, Mayor

ZONING CERTIFICATE OF APPROVAL

State of North Dakota)
 City of Jamestown)
 By a resolution duly passed by the City Planning and Zoning Commission of Jamestown, North Dakota on the 16 day of March, 2023, A.D., the shown plat of "University of Jamestown Athletic Second Addition", within the northeast quarter of Section 25, T140N, R64W of the Fifth Principal Meridian, being within the City of Jamestown, Midway Township, Stutsman County, North Dakota was duly approved and accepted.

Dated 3/20/23
 [Signature] David S. Dillman
 Planning and Zoning Commission Secretary
 [Signature] Daren Peterka
 Planning and Zoning Commission Chairman

LEGEND

- Found - Monument As Described
- Set #5 - 1/8" Rebar With Plastic Cap PLS 4358
- Reset #5 - 1/8" Rebar With Plastic Cap PLS 4358
- Parcel Boundary
- Lot Boundary
- Vacated Lot and/or Block Boundary
- Easement Boundary
- Easement Centerline
- Section Line and/or Quarter (1/4) Line
- Survey or Plan Tie Line

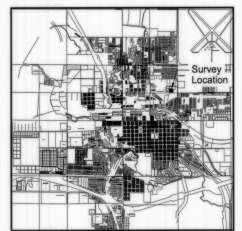
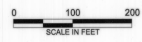

VICINITY MAP

ENGINEER'S CERTIFICATE OF APPROVAL

I have examined the attached plat of "University of Jamestown Athletic Second Addition", within the northeast quarter of Section 25, T140N, R64W of the Fifth Principal Meridian, being within the City of Jamestown, Midway Township, Stutsman County, North Dakota and hereby give my approval.

Dated 3/20/23
 [Signature] Travis Dillman
 Travis Dillman, City Engineer

OWNER'S CERTIFICATE OF APPROVAL AND DEDICATION

University of Jamestown, formerly known as Jamestown College, being an Owner and Proprietor of the above described tract of land has caused said tract of land to be platted as "University of Jamestown Athletic Second Addition" shown on the plat and do hereby agree to said platting, dedication of easement, and vacation of portions of lots and/or blocks as shown.

[Signature] Dr. Polly Peterson, President

All adjacent & current taxes and special assessments are paid and TRANSFER ACCEPTED this 16 day of March, 2023.
 By [Signature] Stutsman County Auditor
 County of Stutsman)

OWNER'S CERTIFICATE OF APPROVAL AND DEDICATION

Jamestown College Foundation, Inc., a North Dakota Non-Profit Corporation, being an Owner and Proprietor of the above described tract of land has caused said tract of land to be platted as "University of Jamestown Athletic Second Addition" shown on the plat and do hereby agree to said platting, dedication of easement, and vacation of portions of lots and/or blocks as shown.

[Signature] Dr. Polly Peterson, President

DENISE MCCLLEAN
 Notary Public
 State of North Dakota
 My Commission Expires November 22, 2025

Type	Grantee	Date	Document Number	Comments
Dedication of Land For Highway Purpose	City of Jamestown, N. D.	April 14, 1959	167986	Described easement is west of the parcel being platted.
Grant of Easement	City of Jamestown, State of North Dakota	January 17, 1961	244742	Described easement is north of the parcel being platted.
Grant of Easement	City of Jamestown, N. D.	January 17, 1961	244743	Described easement is west of the parcel being platted.
Grant and convey a right of way	City of Jamestown, North Dakota	May 4, 1961	245638	Described easement is north of the parcel being platted.
Grant of Easement	City of Jamestown, State of North Dakota	August 24, 1961	248503	Described easement is east of the parcel being platted.
Easement	City of Jamestown, North Dakota	April 30, 1979	X81968	Described easement is south of the parcel being platted.
Right of Way Easement	Other Tall Power Company, a Minn. corp.	October 12, 1979	X89223	Described easement is southeast of the parcel being platted.
Grant of Easement	City of Jamestown, State of North Dakota	January 17, 1961	244742	Described easement is north of the parcel being platted.
Grant of Easement	City of Jamestown, N. D.	January 17, 1961	244743	Described easement is west of the parcel being platted.
Grant and convey a right of way	City of Jamestown, North Dakota	May 4, 1961	245638	Described easement is east of the parcel being platted.
Grant of Easement	City of Jamestown, State of North Dakota	August 24, 1961	248503	Described easement is south of the parcel being platted.
Right of Way Easement	Other Tall Company, a Minn. corp.	March 6, 1980	X66023	Described easement is southeast of the parcel being platted.
Easement	Jamestown College Pooled Income Fund (a Trust)	April 17, 1980	X66468	Easement terminated in 2000.
Easement	Jamestown College Pooled Income Fund (a Trust)	April 17, 1980	X66469	Easement terminated in 2000.
Easement	Jamestown College Pooled Income Fund (a Trust)	April 17, 1980	X66470	Easement terminated in 2000.
Right of Way Easement	Other Tall Power Company, a Minn. Corp.	June 10, 1980	X66915	Described easement is north of the parcel being platted.
Utility Easement	Montana-Dakota Utilities Co., a corp	November 16, 1988	X98778	Easement includes all of the parcel being platted as it includes the S1/2NE1/4 of Section 25.
Easement	John A. Schoeler and F. Maurine Schoeler	August 5, 1992	X119324	Described easement is north of the parcel being platted.
Easement Agreement	The City of Jamestown, a corp.	March 22, 1999	X141043	Described easement is north of the parcel being platted.
Agreement to Convey Easement	Jamestown College, a corp.	April 28, 1994	X121801	Described easement is west of the parcel being platted.
Easement Agreement	The City of Jamestown, a corp.	May 27, 1999	X141948	Described easement is northwest of the parcel being platted.
Easement Agreement	City of Jamestown, ND Municipal Corp.	July 13, 2007	X179358	Described easement is north of the parcel being platted.
Easement Agreement	Maple Acres Condominium Association	March 19, 2008	X182185	Described easement is northwest of the parcel being platted.
Electric Line Easement	Other Tall Company, a Minn corp.	March 27, 2013	X203489	Described easement is north of the parcel being platted.
City of Jamestown Stormwater Easement	City of Jamestown, ND a ND municipal corp.	April 7, 2017	0220547	Described easement is east of the parcel being platted.

UNIVERSITY OF JAMESTOWN ATHLETIC SECOND ADDITION
 Replat of Portions of Blocks 6, 7 and 9 of Jamestown College Subdivision,
 and Lot 2, Block 1 of University of Jamestown Athletic Addition
 Within the NE1/4 of Section 25, T140N, R64W
 Jamestown, North Dakota
 ADDITION PLAT
 Surveyed By: Paul Jeske
 Project No.: 23-00-007
 Drawn By: Nick Cochran
 Designed By: Nick Cochran
 Checked By: Daren Peterka
 Date: May 8, 2023

Interstate Engineering, Inc.
 P.O. Box 20255
 1803 12th Avenue SW
 Jamestown, ND 58402-2025
 Fax (701) 252-0203
 Fax (701) 252-0203

INTERSTATE ENGINEERING
 Professionals you need, people you trust.
 Sheet Number 1