

TWP. 139 N. - RGE. 68 W.

PLAT OF
SOUTHEAST ADDITION
 TO MEDINA — NORTH DAKOTA

SCALE
 1 INCH = 100 FT.



ENGINEER'S CERTIFICATE

I, E.C. Stee, Registered Civil Engineer in the State of North Dakota, hereby certify that I surveyed Block s 1 and 2 of the Southeast Addition to the City of Medina, as shown and described hereon and caused same to be marked by iron markers as shown on the annexed plat, which I further certify to be correct to the best of my knowledge and belief.

E.C. Stee
 Registered Civil Engineer

STATE OF NORTH DAKOTA }
 COUNTY OF BURLEIGH } SS

On this 20th day of March, 1948, before me personally appeared E.C. Stee, known to me to be the same person described in and who executed the foregoing instrument, and acknowledged to me that he executed the same of his own free will and deed.

A.J. Dault
 Notary Public, Burleigh County, N.D.
 My Commission Expires 10-10-53

Know all men by these presents that the City of Medina, a municipal corporation, has caused Blocks 1 and 2 of the Southeast Addition to the City of Medina to be surveyed and platted as shown on annexed plat.

In Testimony Whereof, the said City of Medina has caused these presents to be executed in its corporate name by its Mayor and attested by its Auditor and its corporate seal to be hereunto affixed this 25th day of March 1948.

Attest: *E.H. Kohlhoff*
 Auditor

CITY OF MEDINA
 By *Dan Preszler*
 Mayor



STATE OF NORTH DAKOTA }
 County of Stutsman } SS

On this 25 day of March, 1948, personally appeared Dan Preszler and E.H. Kohlhoff to me known to be the Mayor and Auditor respectively, of the City of Medina, that is described in, and that executed the foregoing instrument, and acknowledged to me that said City of Medina executed the same.

Reinhold K. Hartmann
 Notary Public, Stutsman County, N.D.
 My Commission Expires 3-16-51



E. C. STEE
 CONSULTING ENGINEER
 BISMARCK — NORTH DAKOTA

Handwritten notes and signatures at the bottom of the page.

BISMARCK—NORTH DAKOTA
CONSULTING ENGINEER
E. C. STEE



My Commission Expires 3-16-21

Notary Public, Stutsman County, N.D.

[Signature]

instrument, and acknowledged to me that said City of Medina executed the same.

of the City of Medina, that is described in, and that executed the foregoing

President and E.H. Kohlhoff to me known to be the Mayor and Auditor respectively.

On this 22 day of March, 1918, personally appeared Dan

County of Stutsman }
STATE OF NORTH DAKOTA }

Attest: *[Signature]*
Auditor

By *[Signature]*
Mayor
CITY OF MEDINA

corporate seal to be hereunto affixed this 22 day of March, 1918.

executed in its corporate name by its Mayor and attested by its Auditor and its

In Testimony Whereof, the said City of Medina has caused these presents to be

surveyed and platted as shown on annexed plat.

has caused Blocks 1 and 2 of the Southeast Addition to the City of Medina to be

Know all men by these presents that the City of Medina, a municipal corporation,

My Commission Expires 10-10-23

Notary Public, Burleigh County, N.D.

[Signature]

own free will and deed.

foregoing instrument, and acknowledged to me that he executed the same of his

E.C. Stee, known to me to be the same person described in and who executed the

On this 20th day of March, 1918, before me personally appeared

County of Burleigh }
STATE OF NORTH DAKOTA }

Registered Civil Engineer

to the best of my knowledge and belief.

tion markers as shown on the annexed plat, which I further certify to be correct

City of Medina, as shown and described herein and caused same to be marked by

certify that I surveyed Block 1 and 2 of the Southeast Addition to the

I, E.C. Stee, Registered Civil Engineer in the State of North Dakota, hereby

ENGINEER'S CERTIFICATE

TO MEDINA—NORTH DAKOTA

SOUTHEAST ADDITION

PLAT OF

TWP. 139N - RGE. 68 W.

SCALE
1 INCH = 100 FT.

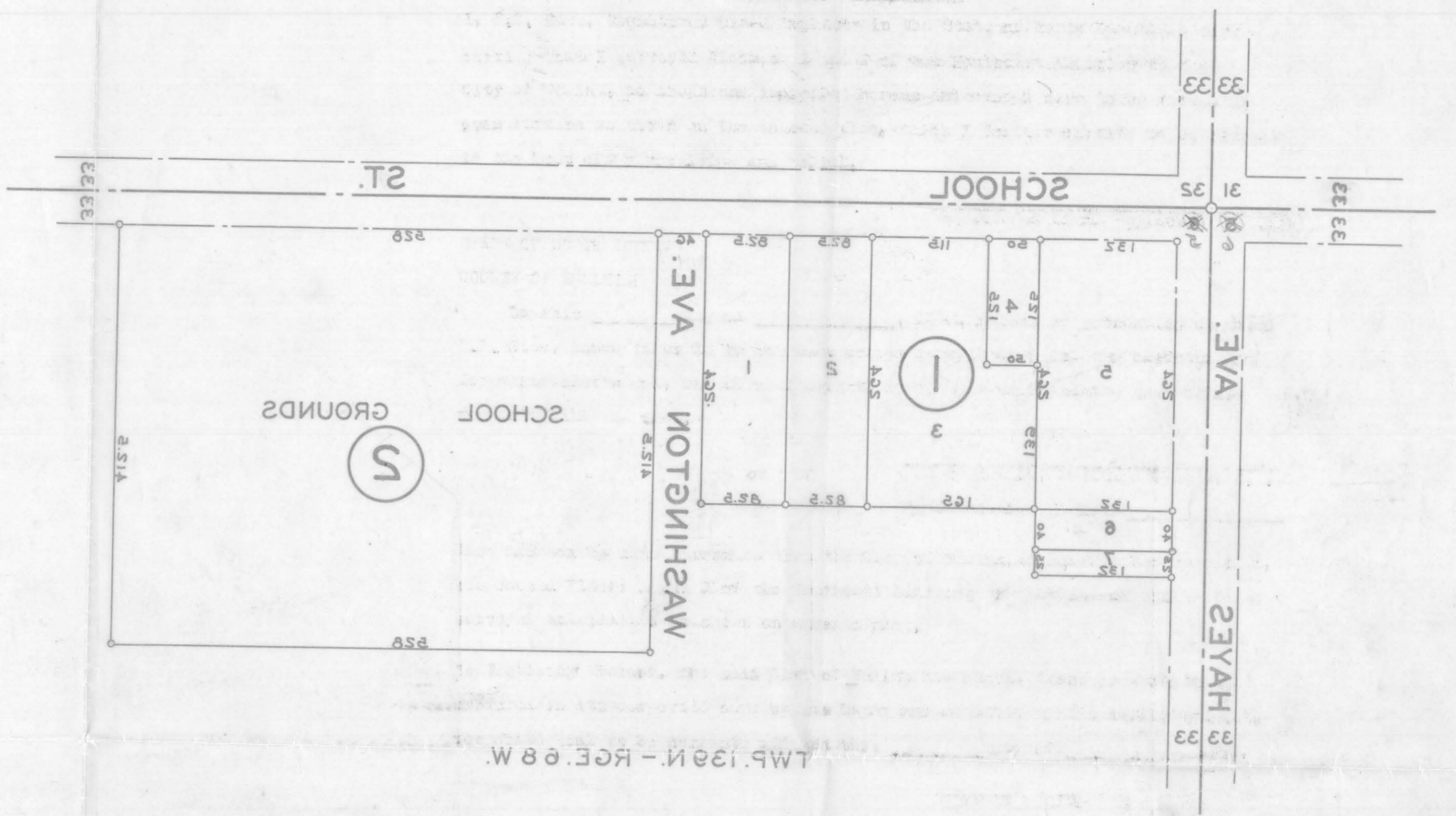

STATE OF NORTH DAKOTA, ss }
COUNTY OF STUTSMAN }

1918 at 11 o'clock A.M.,
and was duly recorded in Book A of
Plats Page 238-239
By *[Signature]*
REGISTERED LAND SURVEYOR

Chg 1.25 ✓