

PLATINUM COMMERCE SECOND ADDITION TO JAMESTOWN, IN THE SE 1/4 OF SECTION 2 - T139N - R64W OF THE 5TH P.M. STUTSMAN COUNTY, NORTH DAKOTA (REPLAT OF LOTS 2 AND 3, BLOCK 1 OF PLATINUM COMMERCE ADDITION)

LEGEND

- PROPERTY CORNER SET 5/8" X 18" REBAR W/SURVEY CAP LS #3213
- PROPERTY CORNER FOUND (REBAR W/SURVEY CAP LS #5510)
- 174.22M DISTANCE MEASURED THIS SURVEY
- (174.17PP) DISTANCE PREVIOUSLY PLATTED

BASIS OF BEARING= NORTH DAKOTA STATE PLANE SOUTH ZONE
ALL DISTANCES ARE GROUND

25TH STREET SW

LOT 1 BLOCK 1
0.88 ACRES

LOT 2, BLOCK 1
PLATINUM COMMERCE ADDITION
(VACATED BY THIS PLAT)

LOT 2 BLOCK 1
1.60 ACRES

LOT 3, BLOCK 1
PLATINUM COMMERCE ADDITION
(VACATED BY THIS PLAT)

LOT 1, BLOCK 1
PLATINUM COMMERCE
ADDITION



SCALE: 1" = 30'

LOT 1, BLOCK 1
PLATINUM COMMERCE ADDITION

VICINITY MAP

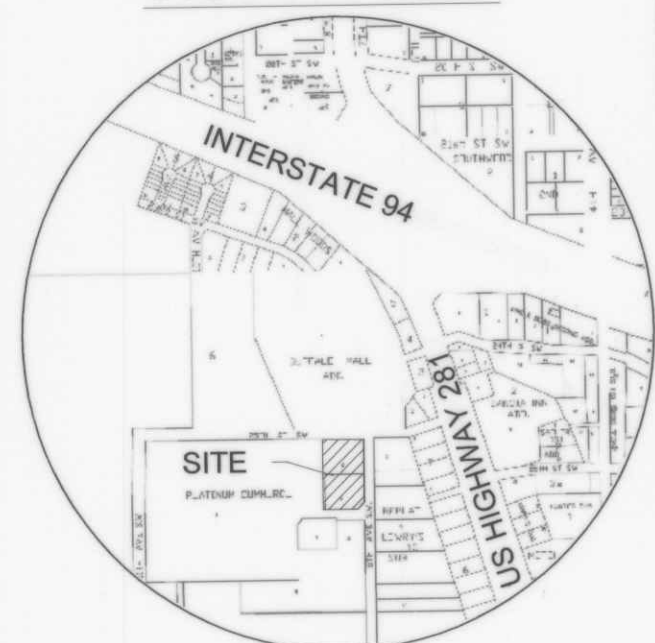

Declaration
The parties set forth herein as owners and proprietors of the land herein described together with Randy D. Bacon, Helms and Associates, a registered land surveyor in the state of North Dakota, hereby declare and make known that said owners and proprietors recently caused to be platted a portion of the SE 1/4 of Section 2, T-139N -R64W of the 5th P.M. Stutsman County, North Dakota, here in after known as Platinum Commerce Second Addition. The plat of which is hereby attached was made by Randy D. Bacon in accordance with the statutes of the State of North Dakota and the Ordinances of the City of Jamestown, North Dakota in such case made and provided a description of the situation and boundaries of said plat being as follows:

Existing Plat Legal Description
Lot 2 and Lot 3, Block 1 of Platinum Commerce Addition to Jamestown, in the SE 1/4 of Section 2-T139N-R64W of the 5th P.M. Stutsman County, North Dakota.

New Plat Legal Description
Lot 1 and Lot 2, Block 1 of Platinum Commerce Second Addition to Jamestown, in the SE 1/4 of Section 2 T139N - R64W of the 5th P.M., Stutsman County, North Dakota.

Surveyors Certificate
I, Randy D. Bacon, Helms and Associates, a Registered Land Surveyor in the state of North Dakota, do hereby certify that this plat is a true and correct representation of the survey of "Platinum Commerce Second Addition", to Jamestown, Stutsman County, North Dakota, as surveyed by me or under my direct supervision and that all distances are correct, the monuments are in place as shown on the plat and the outside boundary lines are correctly designated as shown on the plat in accordance with the statutes of the state of North Dakota and the ordinances of the city of Jamestown to the best of my knowledge and belief.

In witness whereof I have hereunto set my hand this 11th day of January, 2014

Randy D. Bacon
Randy D. Bacon Registration No. 3213

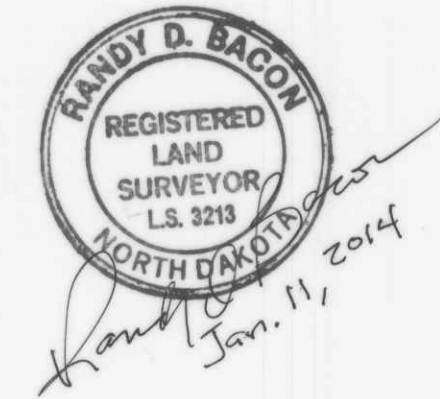

State of South Dakota)
)SS
County of Brown)

On this 11 day of Jan, 2014, Before me, a Notary Public, personally appeared Randy D. Bacon, known to me to be the same person described herein and who executed the within and foregoing instrument and acknowledged before me that he executed the same.



Deanna D. Helms
Notary Public, S.D. State
My Commission Expires: 1-31-20

Owner's Certificate
Know all men by these presents that Wal-Mart Stores Incorporated, a Delaware Corporation, the undersigned, hereby certify that we are the absolute and unqualified owners of all the land included in the within and foregoing plat; that the plat has been made at our request and under our direction for the purposes indicated therein; which said property as so surveyed and platted shall hereafter be known as Platinum Commerce Second Addition to Jamestown as shown by this plat, and that development of the land included within the boundaries of said addition shall conform to all existing applicable easements, zoning, subdivision, and erosion and sediment control regulations.
In witness whereof I have hereunto set my hand this 10 day of January, 2014.

Wal-Mart Stores Incorporated
By: Joanne Howell
Title: Director, Land Development

Declaration of Vacation
Know all men by these presents that we the undersigned hereby declare to vacate Lot 2 and Lot 3, Block 1, Platinum Commerce Addition and Utility and Drainage Easements between lot line common to said Lot 2 and 3, as recorded as document X179078 on June 22, 2007 in the Stutsman County, ND Recorders Office.
This in witness whereof I have hereunto set my hand this 10 day of January, 2014.

Wal-Mart Stores Incorporated
By: Joanne Howell
Title: Director, Land Development

Corporate Acknowledgement
State Of Arkansas)
County Of Benton)SS
On this the 10 day of January, 2014, before me, the undersigned officer, personally appeared Joanne Howell, Director, Land Development of Wal-Mart Stores a Corporation, and that he/she, as such Director, Land Development being authorized so to do executed the foregoing instrument for the purposes therein contained. By signing the name of the Corporation by himself/herself as Director, Land Development.
In witness whereof I hereunto set my hand and official seal.

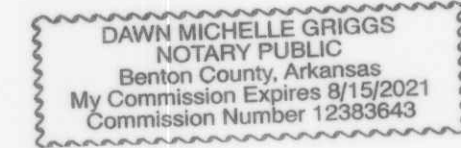

Dawn Michelle Griggs
Notary Public, Arkansas State
My Commission Expires: August 15, 2021

Planning and Zoning Certificate of Approval
State of North Dakota) SS
City of Jamestown)
By a resolution duly passed by the City Planning Commission of Jamestown, North Dakota on the 9th day of December 2013 the attached plat of Platinum Commerce Second Addition to Jamestown, Stutsman County, North Dakota was duly approved and accepted.
Dated 1-13-14 Attest Joanne Howell
Secretary-Planning and Zoning Commission

David S. Gillespie
Chairman-Planning and Zoning Commission

I have examined the attached plat of "Platinum Commerce Second Addition" to Jamestown, Stutsman County, North Dakota and hereby give my approval.
Dated 1-13-14 [Signature]
Jamestown City Engineer

City Council Approval
State of North Dakota) SS
City of Jamestown)
By a resolution duly passed by the City Council of Jamestown, North Dakota on the 6th day of January 2014 the attached plat of Platinum Commerce Second Addition to Jamestown, Stutsman County, North Dakota was duly approved and accepted and the plat thereof ordered filed in the office of the County Recorder of Stutsman County and a copy of same to be filed in the office of the City Auditor, and the office of the City Engineer.
Dated 1-13-14
Attest [Signature]
City Administrator Jamestown, North Dakota

Steve Anderson
Mayor of Jamestown, North Dakota



STUTSMAN COUNTY RECORDER Doc #0207095
I certify that this instrument was filed and recorded on 1/13/2014 at 11:28 AM. Fee \$20.00
Return To: HELMS & ASSOCIATES PO BOX 111 ABERDEEN, SD 57401
STUTS CO. REC. BY [Signature]
Page 1 of 1



Transfer Accepted
Caren D. Bradley
Aberdeen, Stutsman Co. ND
By [Signature] Deputy

Date: _____

By: _____

Reg. No.: _____

No. _____

221 Brown County Highway 19
P.O. Box 111,
Aberdeen, S.D. 57401
Phone: 605.225.1212,
Fax: 605.225.3189
Email: terrylh@helmsengineering.com

Helms & Associates
CIVIL ENGINEERS & LAND SURVEYORS

Drawn By: TMO	Chk' By: RDB	Proj. No: A-5776	Dwg. No: 5776-PNT	VP. No: x	Date: 10-21-13
---------------	--------------	------------------	-------------------	-----------	----------------

**PLAT OF PLATINUM COMMERCE
SECOND ADDITION
JAMESTOWN, ND**

1 OF 1