

LAMBERT'S ADDITION TO SPIRITWOOD, STUTSMAN COUNTY, DAKOTA TERRITORY.

EDWARD H. FOSTER,
SURVEYOR JAMESTOWN D.T.
DRAUGHTSMAN.
Scale 800 ft to One Inch.

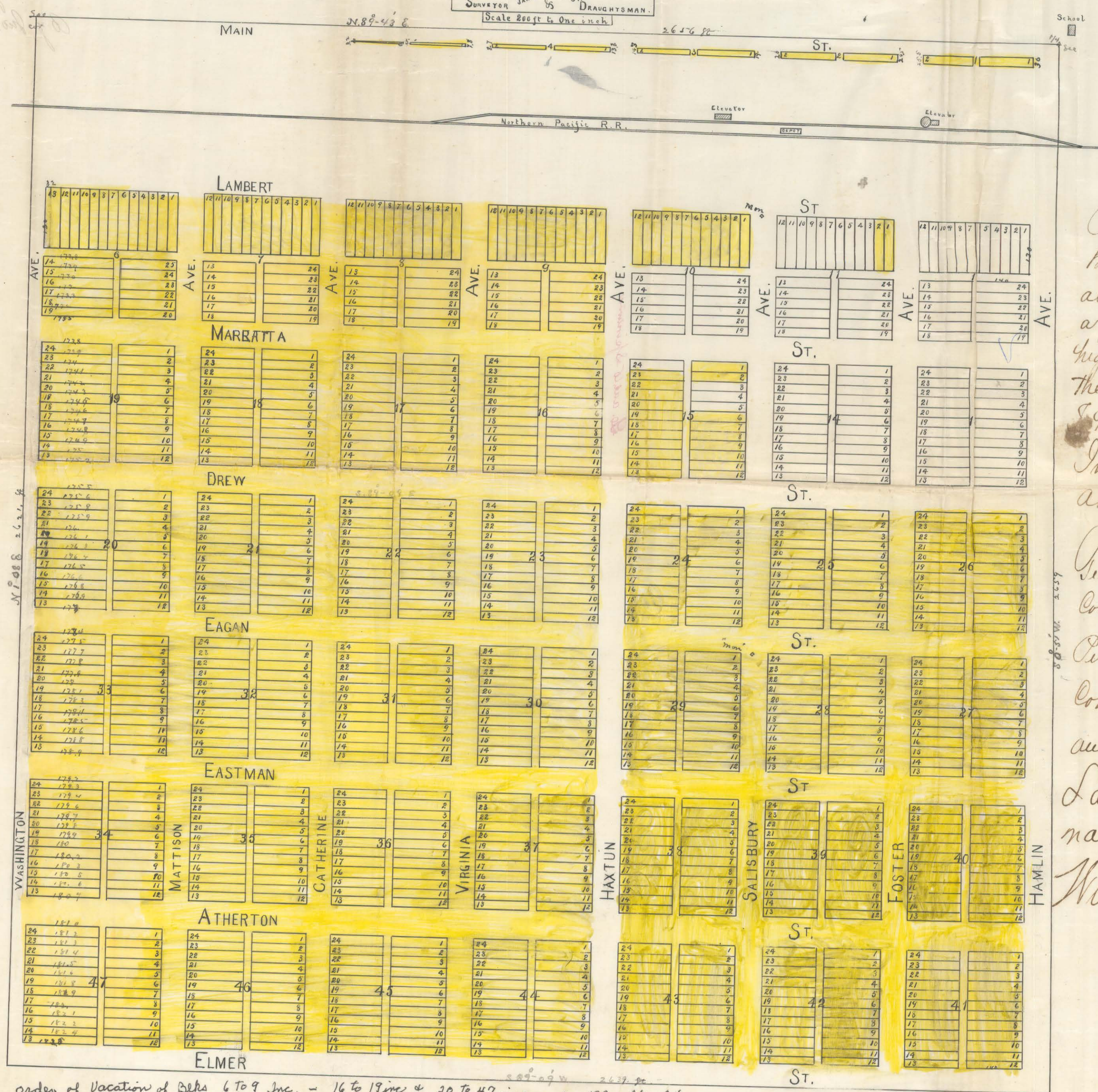

Lambert's Addition to Spiritwood Dakota Ter is located on the N.W. 1/4 of Section 22 Township 140 Range 62 in Stutsman County and Territory of Dakota and is further located as follows: Beginning at the N.W. corner of said Section 22 Thence N 89° 43' E 2656 ft 6 1/4 in corner thence S. 0° 57' W. 2654 ft. Thence S 89° 09' W. 2639 ft. Thence N 1° 08' E. 2621 ft. to place of beginning. All streets are 66 feet wide except main Washington which are 33 feet wide. All alleys are 20 feet wide, all lots not fractional are 140 feet deep, except those fronting on Lambert Street which are 130 feet deep, all lots are 25 feet wide except those west of Rail road track. Good and sufficient shows with marks on them, have been placed at the intersection of the center line of Salisbury street with the south lines of Lambert and Egan streets, to serve as monuments from which to make future surveys, and their positions noted on the plat thus "a" with the word Mon. placed contiguous thereto. The Surveyor Edward H. Foster hereby certifies that the survey of said addition, and the accompanying plat was made by him and are correct and accurate to the best of his knowledge and belief.

Subscribed and sworn to before me this 25th day of April, 1883.
Chas. W. Mills
Alex. Dietrich
 Notary Public, D.T.

Edward H. Foster
 Surveyor

Be it known that I the undersigned, owner and proprietor of that certain tract or parcel of land included in Lambert's Addition to Spiritwood have caused all and singular the real estate described in the certificate herein, to be platted as a Townsite into lots and blocks and streets, avenues and alleys designated on said plat as highways and to the end that the said plat may be recorded as an addition to the town of Spiritwood D.T. according to the laws of the Territory of Dakota and I hereby dedicate the streets, avenues and alleys as public highways.

In Witness Whereof I have hereunto set my hand and seal this 15th day of June A.D. 1883.

J. F. Lambert
 by *W. W. Bill* attorney in fact

Territory of Dakota } ss
 County of Stutsman }
 Personally appeared before me *L. D. Misner* Reg. of Deeds in & for said County, *W. W. Bill* known to me to be the Attorney in fact of *J. F. Lambert* and he acknowledged to me that he signed the name of *J. F. Lambert* to the above Instrument, as principal and his own name as attorney in fact.

In Witness my hand and seal the 16th day of June A.D. 1883,
L. D. Misner
 Reg. of Deeds
 by *Jos. W. Cephus*
 Dep.

Order of Vacation of Belts 6 to 9 Inc. - 16 to 19 Inc & 20 to 47 Inc on pg 172 - BK 24.
 See order of Vacation recorded in Book 10 pg 454