

HYDE PARK ADDITION

To The City of
JAMESTOWN, D.A.

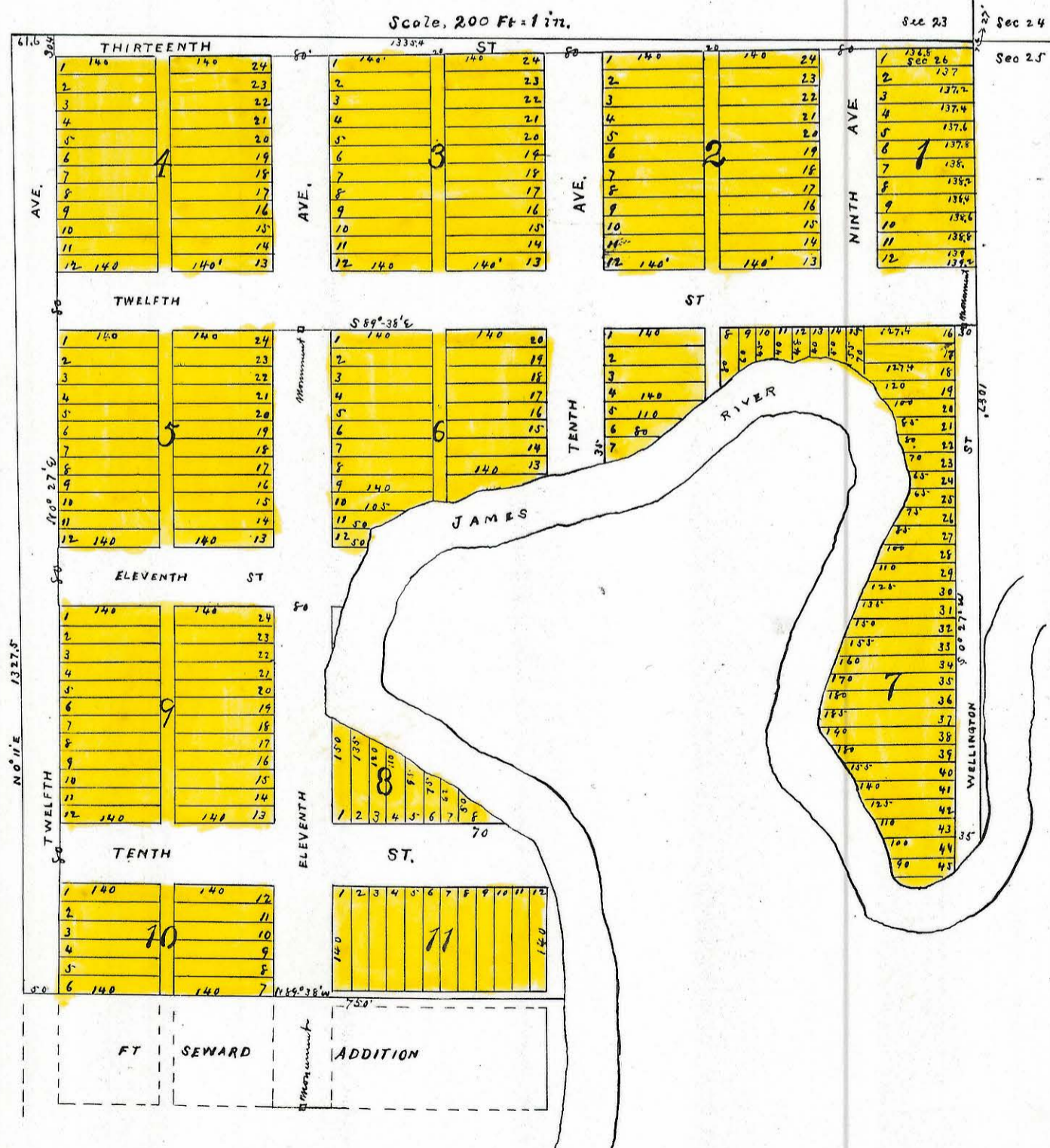

Hyde Park Addition to the City of Jamestown, Stutsman County, Dakota Territory is the Northern part of the east 1/2 of the N.E. 1/4 Section 26 Township 140 N. Range 64 W. and is known as lot XV of Fort Wm. H. Seward Military Reservation. It is more fully described as follows: Beginning at the N.E. corner of above Section 26 and running in a southerly direction along dividing line of Sections 25 and 26 a distance of 1087 feet to the James River thence following the right bank of said river to a point thence N 89° 38' W a distance of 750 feet to a point on the N and S dividing line of above N.E. 1/4 Section 26 thence along said dividing line N 0° 11' E a distance of 1327.5 feet to a point on E and W dividing line of Sections 23 and 26 of above Township and Range thence along said line a distance of 1335.4 feet to place of beginning. The course of all Avenue alleys and Wellington Street is S 0° 27' W. Course of remaining streets is S 89° 38' E. Wellington and Thirteenth Streets and Twelfth Avenue are as shown on the annexed plat. All other streets and Avenues are 80 feet wide. All alleys are 20 feet wide. Numbers of lots are marked in black in front part of lots - Numbers of Blocks are shown in black near centers. Monuments are placed where shown on plat.

All of which we certify to be correct to the best of our knowledge and belief.

J. W. Verner
N. M. Glinlock
SURVEYORS

order of vacation recorded in Bk. H. Pg. 281

See Reversed Additions

MYDE PARK ADDITION

To The City of
JAMESTOWN, DA.

Scale, 200 Ft. = 1 In.



"Myde Park Addition" To the City of Jamestown, Stutsman County, Dakota Territory, is the Northern part of the East 1/2 of the N. E. 1/4 Section 26, Township 140, N., Range 64, W., and is known as Sub. XX of Fort H. Seward Military Reservation. It is more fully described as follows: Beginning at the N. E. corner of above Section 26 and running in a Southerly direction along dividing line of Sections 25 and 26, a distance of 1087 feet to the James River. Thence following the right bank of said River to a point, Thence N 85°-38' W. a distance of 750 feet to a point in the N. and S. dividing line of above N. E. 1/4 Section 26. Thence along said dividing line, N. 0°-11' E., a distance of 1327.5 feet to a point in E. and W. dividing line of Sections 23 and 26, of above Township and Range; Thence along said line a distance of 1335.4 feet, to place of beginning. - The course of all Avenues, Alleys and Wellington Street is 80°-27' W. - Course of remaining Streets is 88°-38' E. - Wellington and Thirteenth Streets and Twelfth Avenue are as shown on the annexed plat; all other Streets and Avenues are 80 feet wide. All Alleys are 20 feet wide. - Numbers of lots are marked in black, in front part of lots. - Numbers of Blocks are shown in block, near centers. Monuments are placed where shown on plat.

All of which we certify to be correct, to the best of our knowledge and belief.
A. M. Verner H. S. McClintock
SURVEYORS.

Sworn and Subscribed before me, this 17 day of June, A.D., 1883
W. J. Lloyd
Notary Public, Stutsman Co., D. T.

Be it known, that I, the undersigned, proprietor of Myde Park Addition to Jamestown, D. T., caused the same to be surveyed and platted, as represented by the plat hereunto annexed; and that I do hereby dedicate all Avenues, Streets, Alleys and Ways, as herein named and designated, to and for the public use. - In witness whereof I have hereunto set my hand and seal at Jamestown, D. T., this 12 day of June, A.D., 1883
Walter J. Hughes
In presence of
A. A. Allen
R. A. Sheets

Territory of Dakota } S.S.
County of Stutsman }
On this 22 day of June, A.D., 1883, personally appeared before me, a Notary within and for above named County, Walter J. Hughes, known to me to be the person who is described in the annexed certificate, as proprietor, and who executed the same and acknowledged to me that he executed it for the purposes therein set forth; freely and voluntarily.
Albert A. Allen
Notary Public, Stutsman Co., D. T.