

# GLENMAC FIRST ADDITION

## DECLARATION

The party set forth as Owners and Proprietors of the land hereinafter described together with Gregory J. Rich, Interstate Engineering, Inc., a Professional Land Surveyor in the State of North Dakota, hereby declare and make known that said Owner and Proprietor recently caused to be re-platted a parcel located within Block 7 of Atkinson & Pannell's Addition, City of Jamestown, Stutsman County, North Dakota, said parcel is more particularly described as being a replat of Lots 1 through 5 and Lots 8 through 12 of Block 7 (including the vacated alley), of Atkinson & Pannell's Addition, City of Jamestown, North Dakota, hereinafter to be known as "GLENMAC FIRST ADDITION". The plat thereof, which is hereby attached, was made by Gregory J. Rich, in accordance with the statutes of the State of North Dakota and the ordinances of the City of Jamestown, Stutsman County, North Dakota, in such case made and provided a description of the situation and boundaries of said plat being as follows:

## BOUNDARY DESCRIPTION

A parcel described as being a replat of Lots 1 through 5 and Lots 8 through 12, Block 7 and the included vacated alley of Atkinson & Pannell's Addition, City of Jamestown, North Dakota. Said parcel is more particularly described as:  
 COMMENCING at the northwest corner of Block 7 of Atkinson & Pannell's Addition, also being a point on the south line of 18th Street SW and the POINT OF BEGINNING;  
 Thence S89°10'44"E on said south line a distance of 300.11 feet to the northeast corner of said Block 7, also being a point on the west line of 2nd Avenue SW;  
 Thence S00°02'55"W on said west line a distance of 250.19 feet to the southeast corner of Lot 5, Block 7 of Atkinson & Pannell's Addition;  
 Thence N89°08'56"W on said west line a distance of 300.05 feet to the southwest corner of Lot 8, Block 7 of Atkinson & Pannell's Addition, also being a point on the east line of 3rd Avenue SW;  
 Thence N00°02'03"E on said east line a distance of 250.03 feet to the point of beginning and the end of this description.  
 Said tract of land contains 75,046 square feet or 1.72 acres more or less and is subject to all easements of a recorded and/or unrecorded nature.

## OWNER'S CERTIFICATE AND DEDICATION

Mac McPherson, CEO/President of Glenmac, LLC, the Owner and Proprietor of the above described tract of land within Block 7 of Atkinson & Pannell's Addition in the City of Jamestown, Stutsman County, North Dakota has caused said tract of land to be platted as "GLENMAC FIRST ADDITION" shown on the attached plat and do hereby agree to said platting.

Mac McPherson  
 CEO/President of Glenmac, LLC

State of North Dakota } SS  
 County of Stutsman

On this 10<sup>th</sup> day of June, 2013, A.D. before me, a Notary Public in said County and State, personally appeared Mac McPherson known to me to be the same person described herein and who executed the within and foregoing instrument and acknowledged to me that he executed the same.

*Kathy Harty*  
 Notary Public  
 State of North Dakota

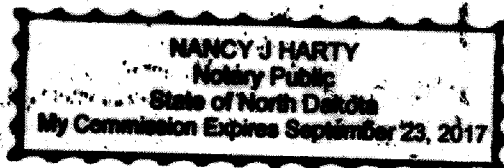

## NEW DESCRIPTIONS

Lots 1 & 2, GLENMAC FIRST ADDITION, City of Jamestown, Stutsman County, North Dakota.

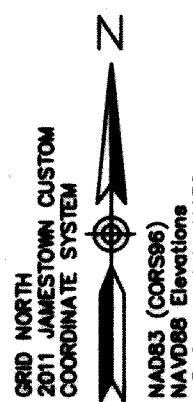

## LEGEND

- SET #5X24 REBAR WITH PLS #6408 CAP ●
- FOUND #5 REBAR WITH PLS #6408 CAP ○
- FOUND #5 REBAR WITH PLS #2352 CAP ○
- FOUND #5 REBAR WITH PLS #2778 CAP ⊙
- PLAT BOUNDARY ———
- LOT BOUNDARY - - - - -
- EXISTING AND PREVIOUS LOT LINES IN PLAT - - - - -
- REPLATTED AND EXISTING PLAT NAME, BLOCK NO. OR LOT NO. LOT DATA IN PLAT
- POINT OF BEGINNING (P.O.B.)
- POINT OF COMMENCEMENT (P.O.C.)
- RECORDED AS DATA (R.A.)

## PLAT LOCATION SKETCH

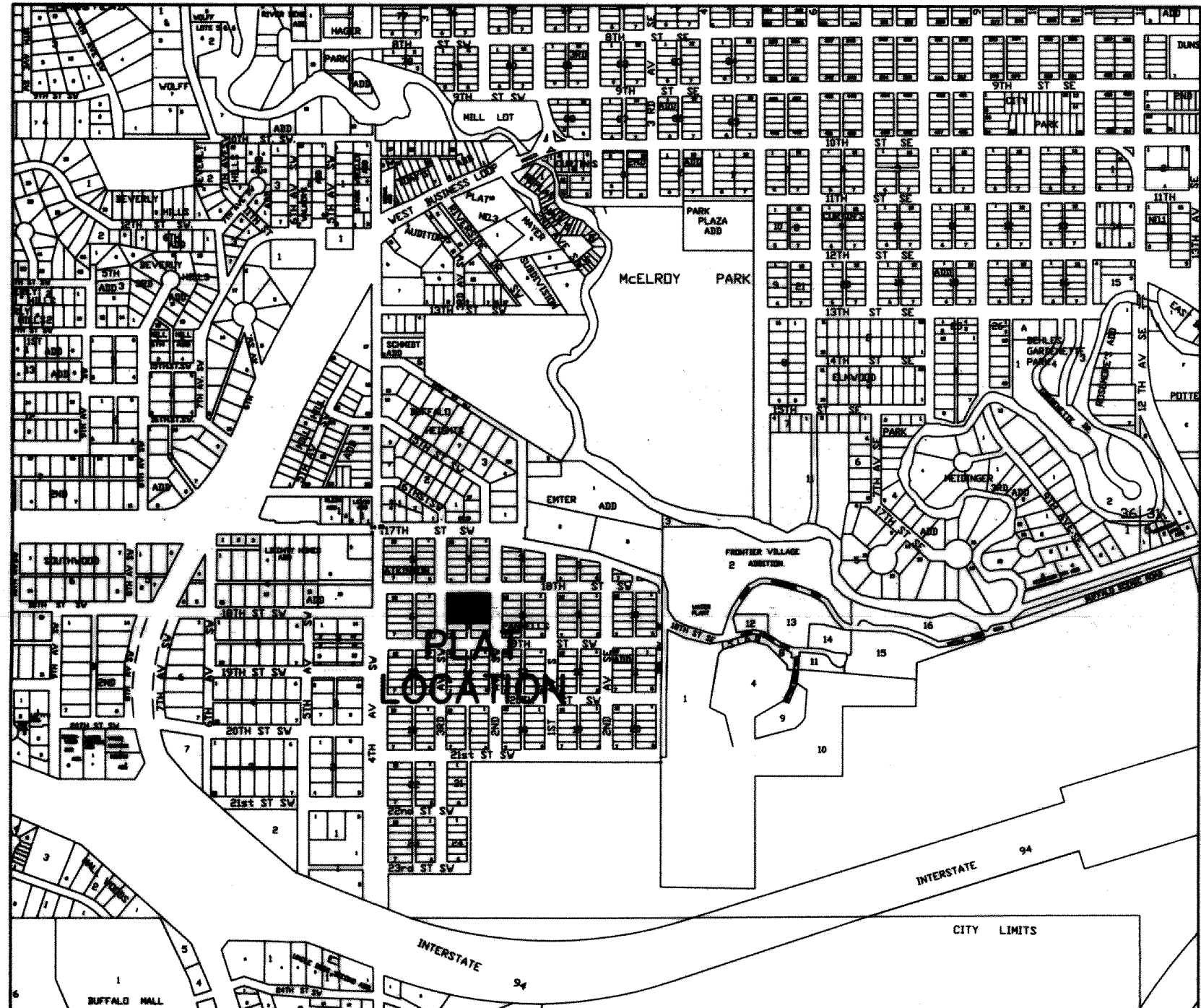

All delinquent & current taxes & special assessments are paid and TRANSFER ACCEPTED this 13<sup>th</sup> day of June 2013  
*Sharon E. Feltz*  
 Stutsman County Auditor  
 By *Sharon E. Feltz* Deputy

## ZONING CERTIFICATE OF APPROVAL

State of North Dakota } SS  
 City of Jamestown

By a resolution duly passed by the City Planning and Zoning Commission of Jamestown, North Dakota on the 13<sup>th</sup> day of June, 2013, A.D., the attached plat of "GLENMAC FIRST ADDITION", within the City of Jamestown, Stutsman County, North Dakota was duly approved and accepted.

Dated \_\_\_\_\_

Attest *David Wilson* Planning and Zoning Commission Secretary  
*David S. Lillend* Planning and Zoning Commission Chairman

## ENGINEER'S CERTIFICATE OF APPROVAL

I have examined the attached plat of "GLENMAC FIRST ADDITION", City of Jamestown, Stutsman County, North Dakota and hereby give my approval.

Dated 6-11-13  
*[Signature]*  
 City Engineer

State of North Dakota } SS  
 City of Jamestown

By resolution duly passed by the City Council of Jamestown, North Dakota on the 13<sup>th</sup> day of June, 2013, A.D., the attached plat of "GLENMAC FIRST ADDITION", City of Jamestown, Stutsman County, North Dakota was duly approved and accepted and the plat thereof ordered filed in the office of the County Recorder of Stutsman County and a copy of same to be filed in the office of the City Auditor and the office of the City Engineer.

Dated 6-11-13

Attest *Joe Fries* City Administrator  
*Katie Anderson* Mayor

## SURVEYOR'S CERTIFICATE

I, Gregory J. Rich, Interstate Engineering, Inc., Jamestown, North Dakota, a Professional Land Surveyor in the State of North Dakota, do hereby certify that this plat is a true and correct representation of the survey of GLENMAC FIRST ADDITION within the City of Jamestown, County of Stutsman, State of North Dakota as surveyed by me or under my direct supervision and that all distances are correct, the monuments are in place as shown on the plat and the outside boundary lines are correctly designated as shown on the plat in accordance with the statutes of the State of North Dakota and the ordinances of the City of Jamestown to the best of my knowledge and belief.

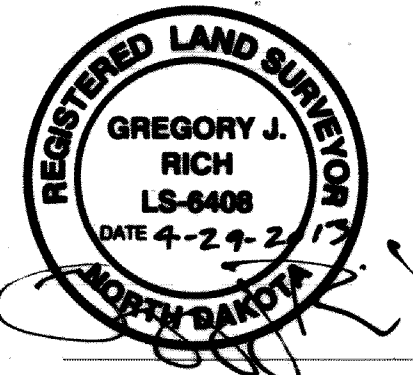

State of North Dakota } SS  
 County of Stutsman

On this 10<sup>th</sup> day of June, 2013, A.D. before me, a Notary Public in said County and State, personally appeared Gregory J. Rich, known to me to be the same person described herein and who executed the within and foregoing instrument and acknowledged to me that he executed the same.

*Denise McClean*  
 Notary Public  
 State of North Dakota

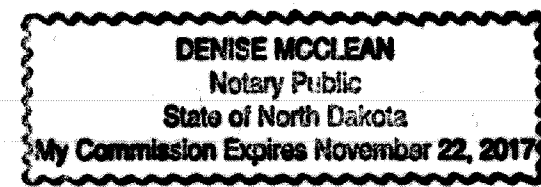

Return To:  
 INTERSTATE ENGINEERING  
 1903 12TH AVE SW  
 JAMESTOWN, ND 58401  
 STUTSMAN COUNTY RECORDER Doc #0204536  
 I certify that this instrument was filed and recorded on 6/13/2013 at 10:04 AM.  
 Linda Chaduck, Recorder  
 By *Gamine Anderson* Deputy

0204536  
 STUTS CO. REC.  
 Page 1 of 1  
 Fee \$10.10

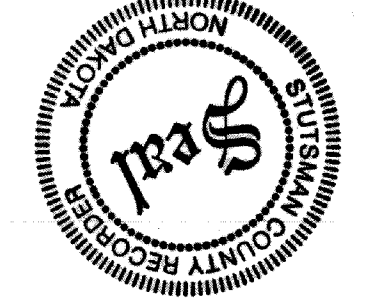

- RECORDED
- ENTERED
- INDEXED
- COMPALED
- SCANNED

Revision No.	Date	By	Description