

COURTENAY CEMETERY

A V E N U E

3

The Courtenay Cemetery Co. of Courtenay N.D., a corporation duly incorporated under the Laws of the State of North Dakota, and owning the following described real estate, to-wit: commencing at the quarter stone at the S.E. corner of the eighth (8) and one hundred forty three (143) and sixty two (62); thence North along the East line of said quarter forty rods; thence West parallel to South line forty rods; thence South parallel to the East line forty rods and thence East along the South line forty rods to point of beginning containing ten (10) acres; and they do hereby dedicate the same to be surveyed and platted as hereon shown, and they do hereby dedicate to the use of the public, subject to such rules as they may adopt for its care and protection, all its avenues, drives and walks.

In witness whereof the President and Secretary have this Seventh day of January 1898 set their hands and seals
 State of North Dakota }
 County of Blountman }
 On this 7 day of January in the year 1898, before me, a Notary Public, personally appeared **W. R. Bennett** President and **Ed. Sanford** Secretary, known to me to be the President and Secretary, respectively, of the Corporation, that is described in and that executed the within instrument, and acknowledged to me that such Corporation executed the same.

A V E N U E



I Frank White being duly sworn do hereby certify that I have surveyed the ground as hereon shown and that the same is correctly platted.
 All distances are given in feet. Scale 30ft-one inch.

Frank White

State of North Dakota }
 County of Barnes }

On this 20th day of May 1895, before me, **O. Mudgett** a Notary Public in and for said County and State, personally appeared **Frank White** known to me to be the person who executed the foregoing instrument, and acknowledged to me that he executed the same.

O. Mudgett
 Notary Public

4

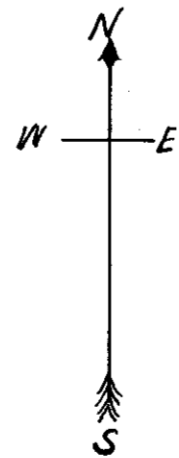

Scale 30ft-one inch

A V E N U E



A V E N U E

A V E N U E

ENTRANCE

PUBLIC HIGHWAY

A V E N U E

A V E N U E

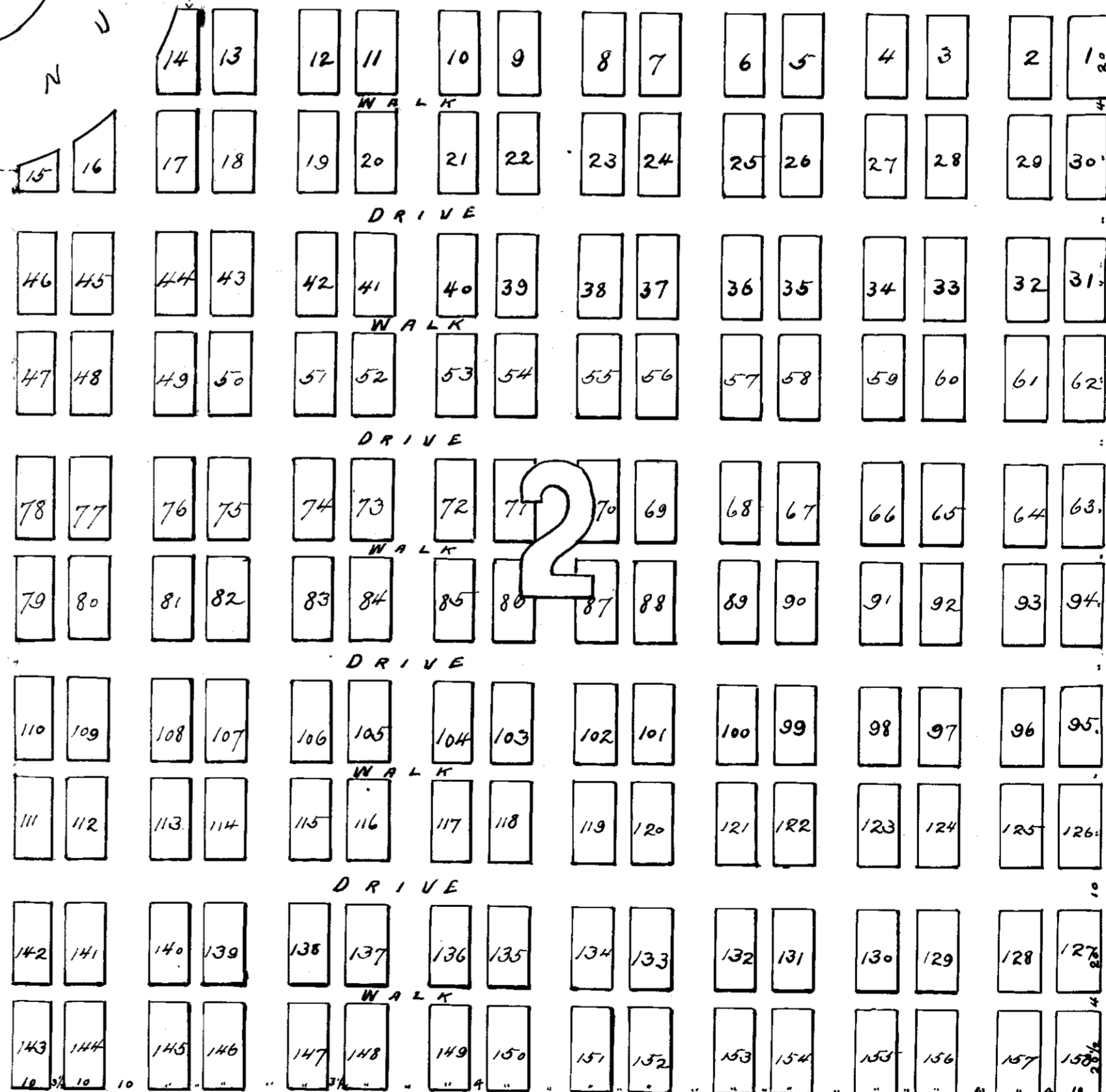

Section Line

PUBLIC HIGHWAY

S.E. Cor. of S. 1/4 Sec. 18 T. 140 N. R. 10 E.