

Dec 29, 2022 - 8:20am - H:\0-PUBLIC WORKS\Engineering\Paving Districts\PD23-41\CAD Drawings\23-41 Drawing.dwg

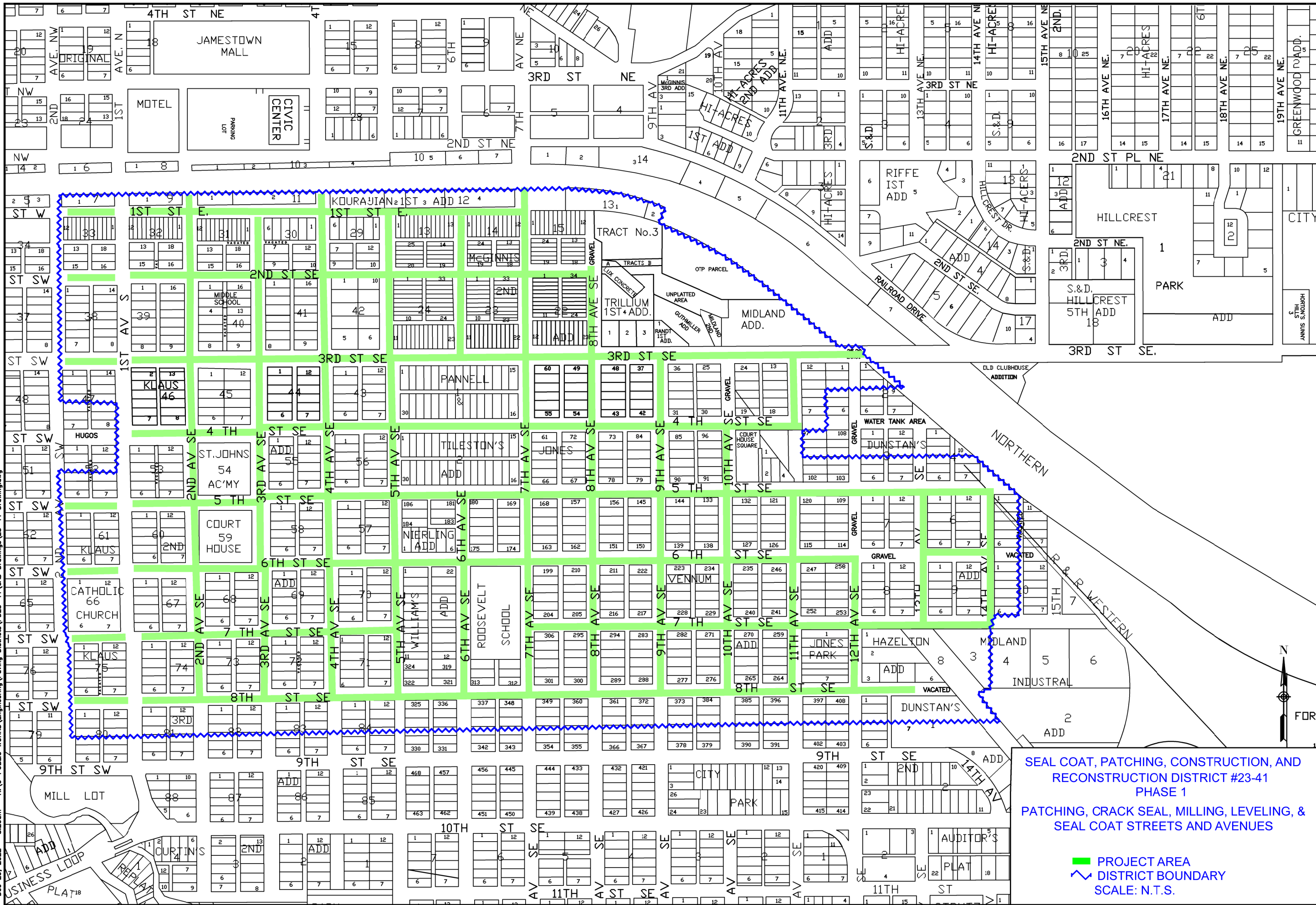

SEAL COAT, PATCHING, CONSTRUCTION, AND RECONSTRUCTION DISTRICT #23-41 PHASE 1
 PATCHING, CRACK SEAL, MILLING, LEVELING, & SEAL COAT STREETS AND AVENUES

■ PROJECT AREA
~ DISTRICT BOUNDARY
 SCALE: N.T.S.



City of
JAMESTOWN
 NORTH DAKOTA

DRAWN BY
 SLH
 DATE
 12/28/2022

CITY OF JAMESTOWN
 ENGINEERING DEPARTMENT



SEAL COAT, PATCHING, CONSTRUCTION & RECONSTRUCTION DISTRICT #23-41 PHASE 1
 PATCHING, CRACK SEAL, MILLING, LEVELING, & SEAL COAT STREETS & AVENUES

SHEET
 1 / 2

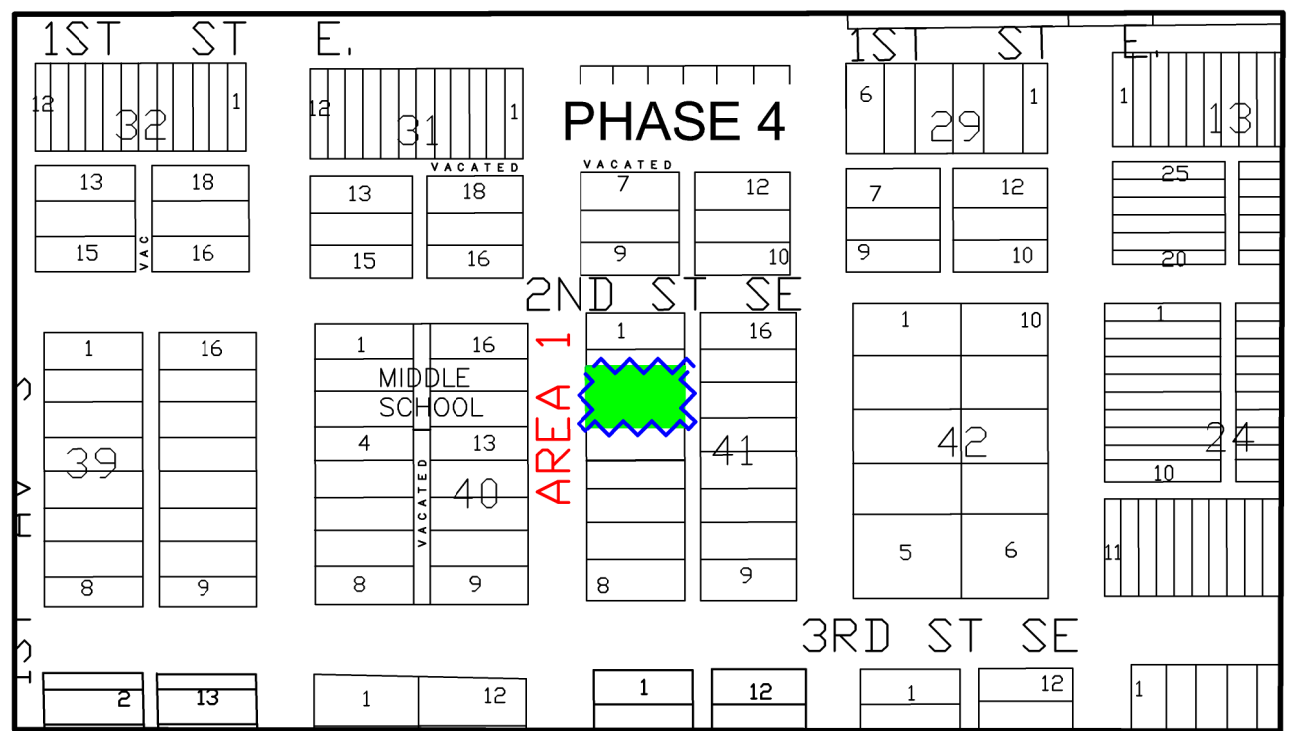
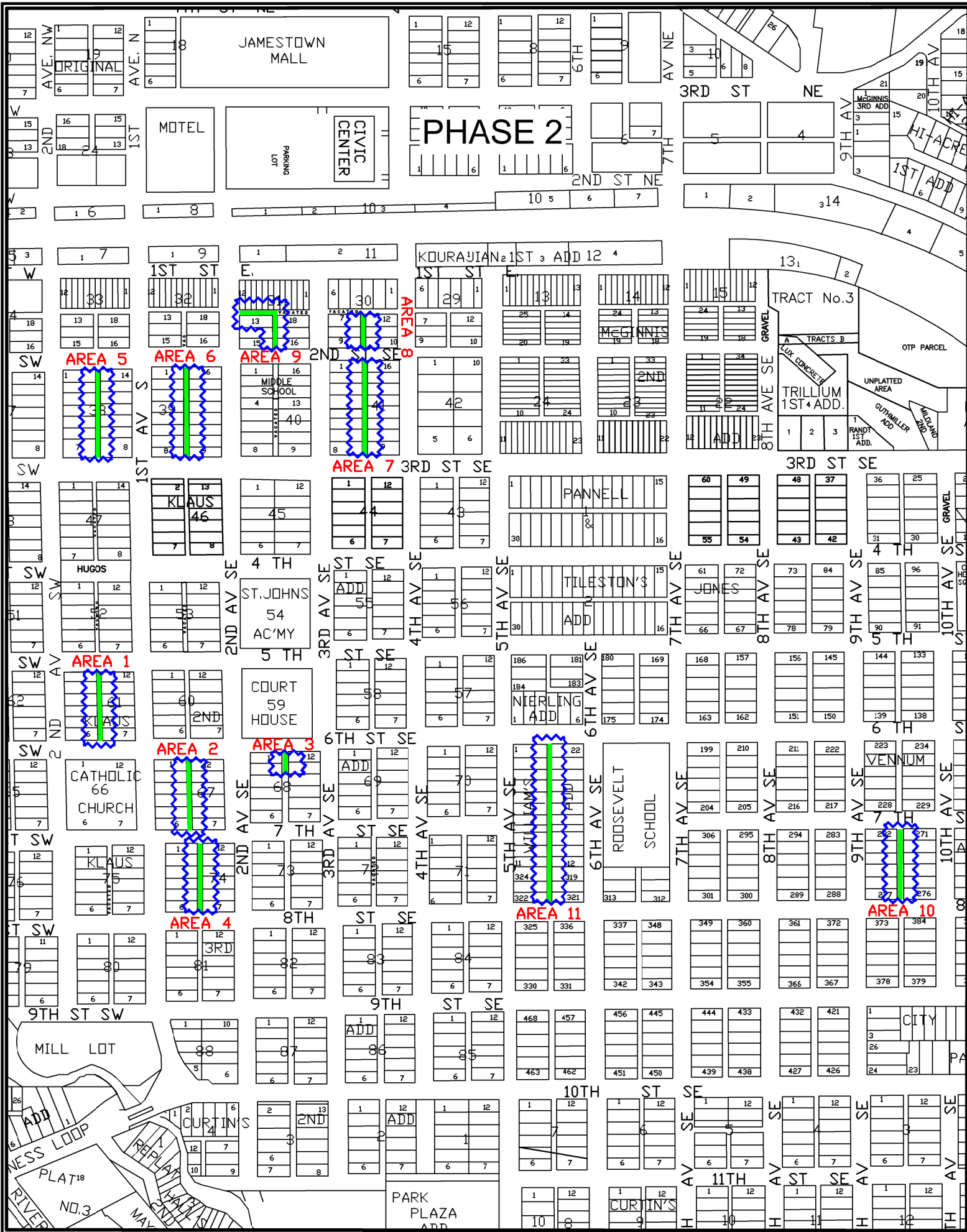
Dec 29, 2022 - 11:11am - H:\O-PUBLIC WORKS\Engineering\ paving Districts\PD23-41\CAD Drawings\23-41 Drawing.dwg



SEAL COAT, PATCHING, CONSTRUCTION, AND RECONSTRUCTION DISTRICT #23-41 PHASE 2, 3, AND 4
 PATCHING, CRACK SEAL, MILLING, LEVELING, AND SEAL COAT ASPHALT ALLEYS, CITY OWNED PARKING LOTS, AND JAMESTOWN SCHOOL DISTRICT OWNED PARKING LOT

 PROJECT AREA
 DISTRICT BOUNDARY
 SCALE: N.T.S.



DRAWN BY
SLH

DATE
12/28/2022

CITY OF JAMESTOWN
ENGINEERING DEPARTMENT

SEAL COAT, PATCHING, CONSTRUCTION & RECONSTRUCTION DISTRICT #23-41 PHASE 2, 3, & 4
 PATCHING, CRACK SEAL, MILLING, LEVELING, & SEAL COAT ASPHALT ALLEYS, CITY OWNED PARKING LOTS, & JAMESTOWN SCHOOL DISTRICT OWNED PARKING LOT