

Jan 05, 2022 - 3:42pm - H:\0-PUBLIC WORKS\Engineering\Paving Districts\PD22-41\Cad Drawings\22-41_PD.dwg

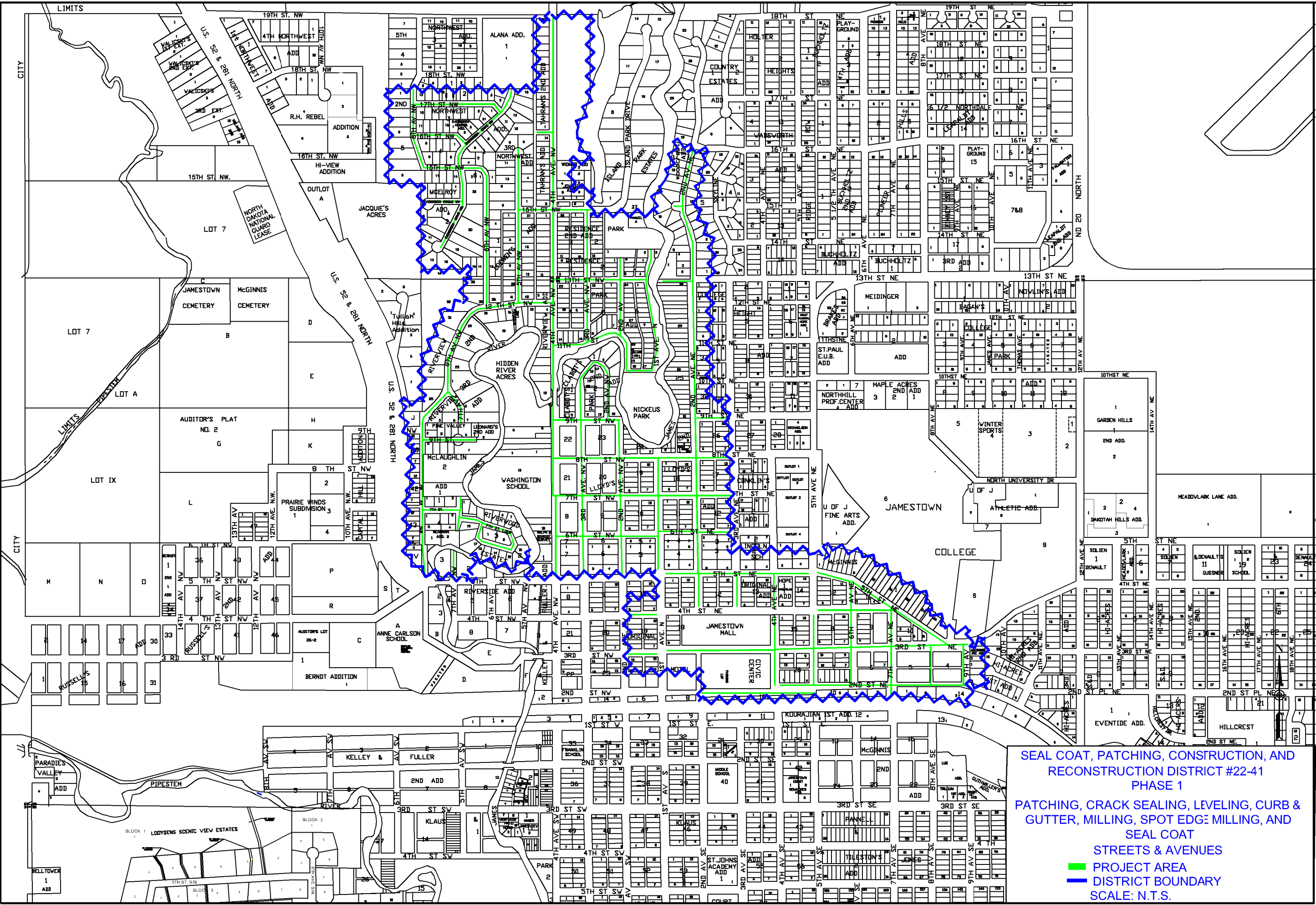

SEAL COAT, PATCHING, CONSTRUCTION, AND RECONSTRUCTION DISTRICT #22-41
 PHASE 1
 PATCHING, CRACK SEALING, LEVELING, CURB & GUTTER, MILLING, SPOT EDGE MILLING, AND SEAL COAT
 STREETS & AVENUES
 PROJECT AREA
 DISTRICT BOUNDARY
 SCALE: N.T.S.



City of
JAMESTOWN
 NORTH DAKOTA

DRAWN BY
 J/L

DATE
 1/5/2022

CITY OF JAMESTOWN
 ENGINEERING DEPARTMENT

SEAL COAT, PATCHING, CONSTRUCTION & RECONSTRUCTION DISTRICT #22-41 PHASE 1
 PATCHING, CRACK SEALING, LEVELING, CURB & GUTTER, MILLING, SPOT EDGE MILLING, AND SEAL COAT, STREETS & AVENUES.

SHEET
 2 / 3

Jan 12, 2022 - 2:06pm - H:\0-PUBLIC WORKS\Engineering\Paving Districts\PD22-41\CAD Drawings\22-41_PD.dwg

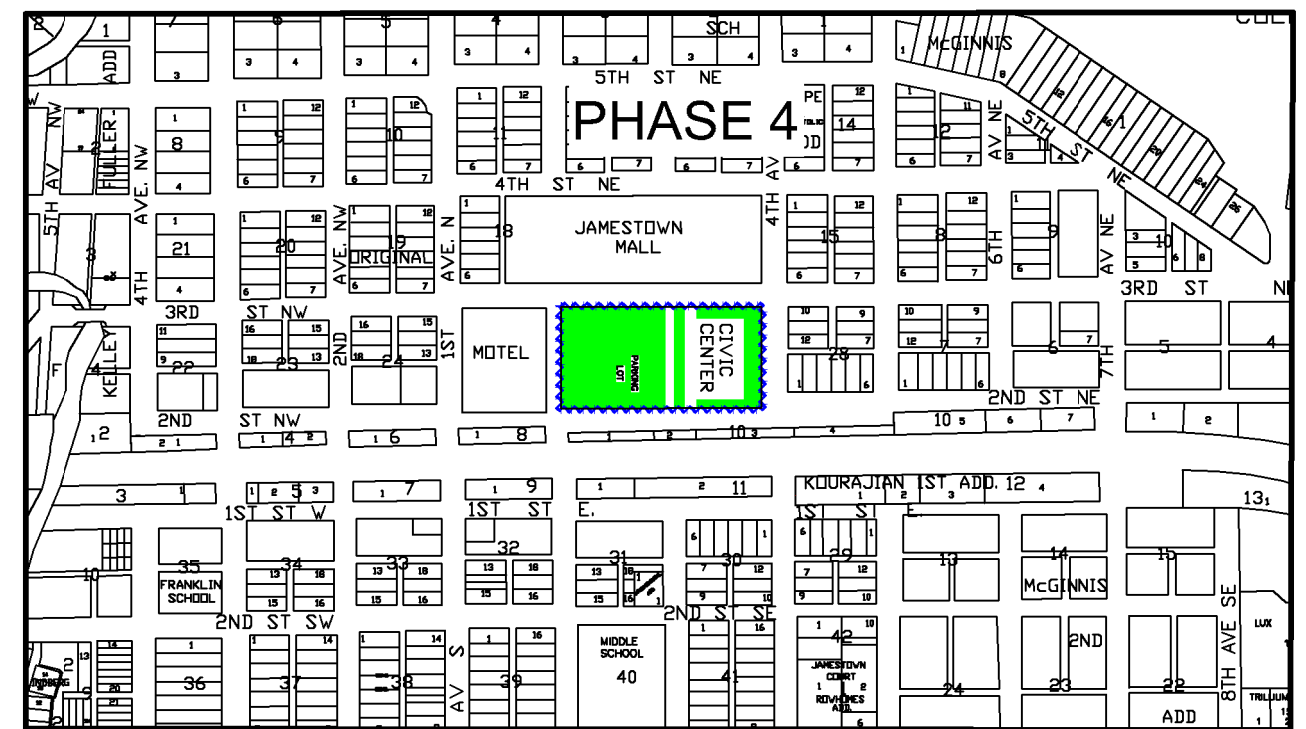
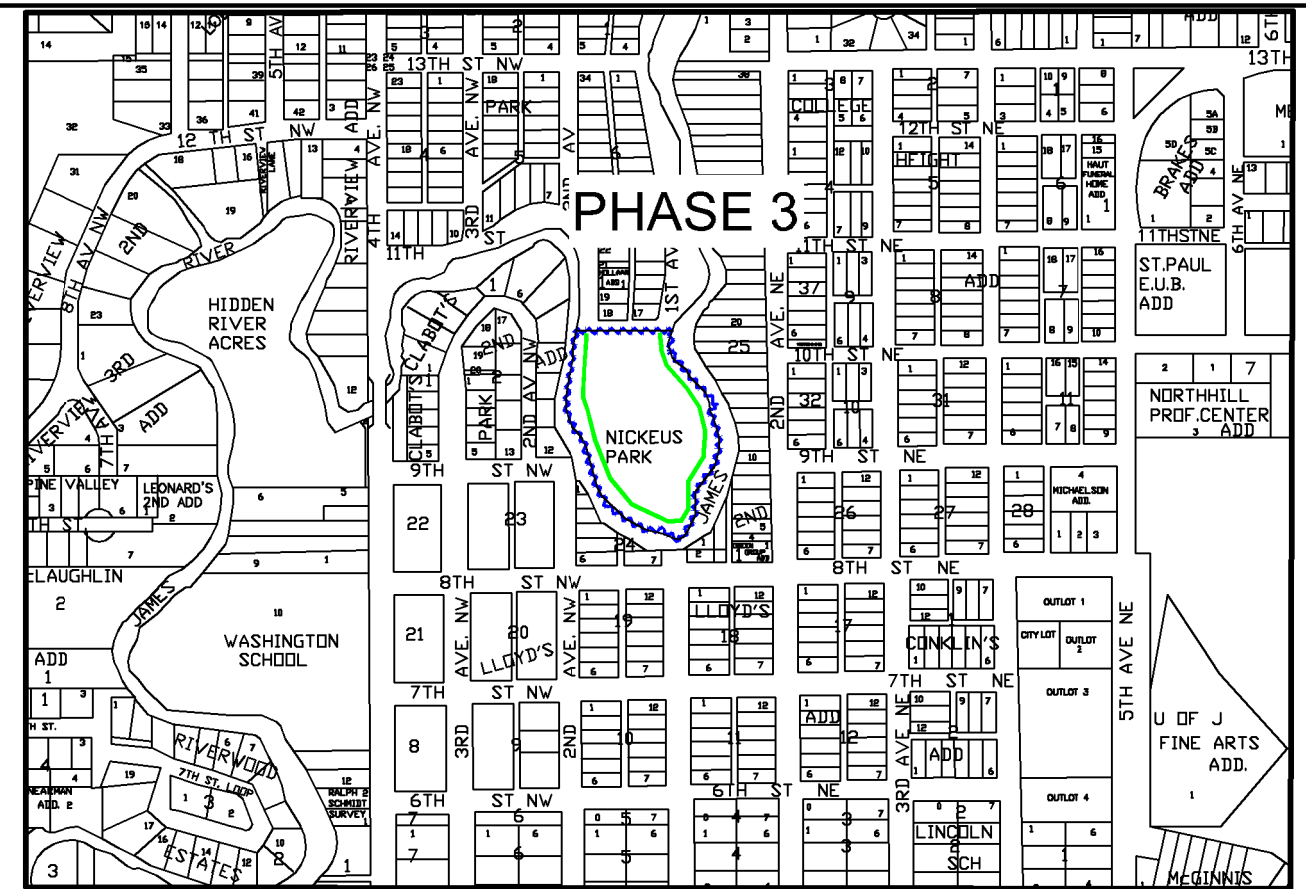
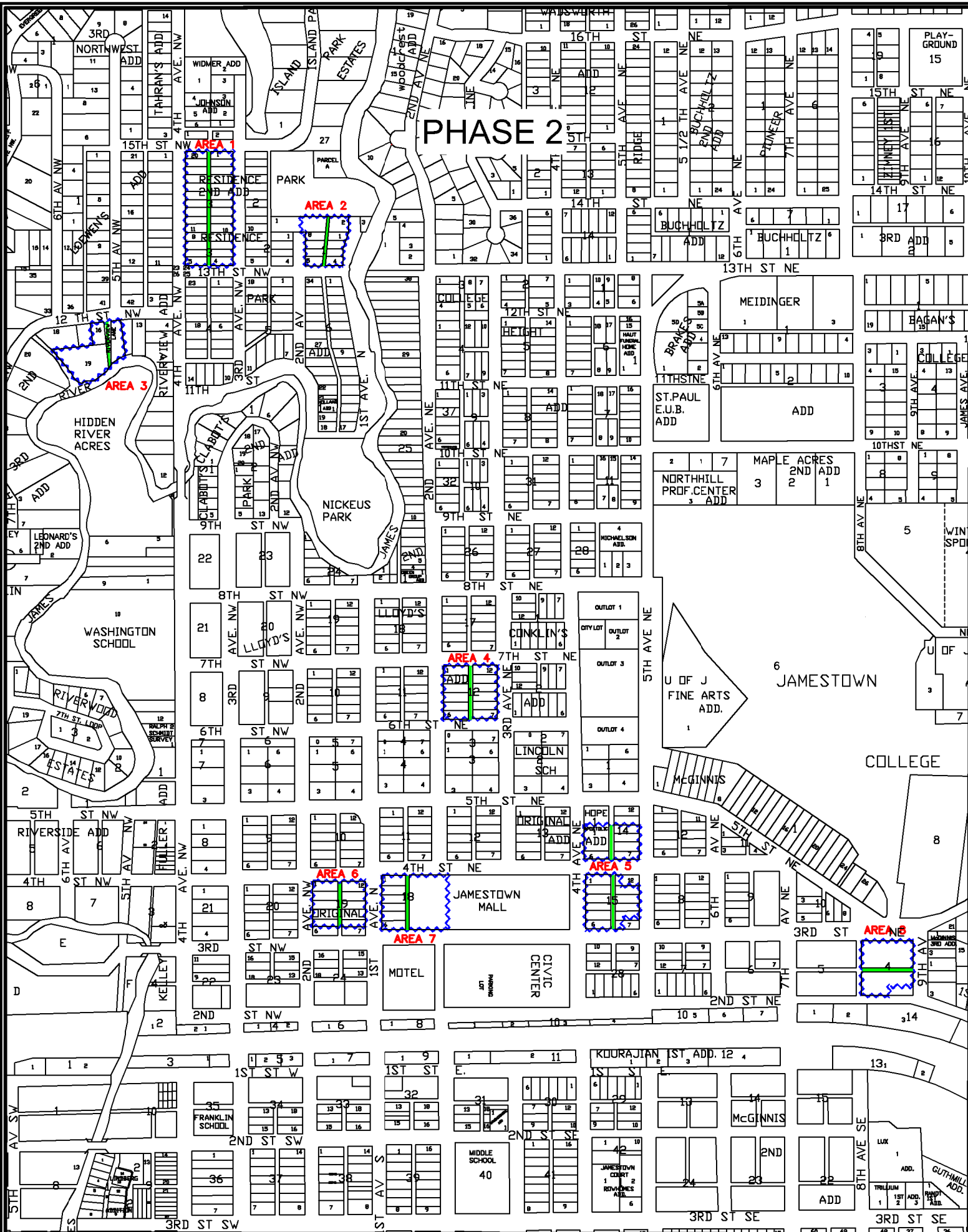

SEAL COAT, PATCHING, CONSTRUCTION, AND RECONSTRUCTION DISTRICT #22-41 PHASE 2, 3, AND 4
 PATCHING, CRACK SEALING, LEVELING, AND SEAL COAT
 ASPHALT ALLEYS, KLAUS PARK ROAD & LOTS, AND CITY OWNED PARKING LOTS
 ■ PROJECT AREA
 ■ DISTRICT BOUNDARY
 SCALE: N.T.S.



DRAWN BY
J/L

DATE
1/5/2022

CITY OF JAMESTOWN
ENGINEERING DEPARTMENT

SEAL COAT, PATCHING, CONSTRUCTION & RECONSTRUCTION DISTRICT #22-41 PHASE 1
 PATCHING, CRACK SEALING, LEVELING, CURB & GUTTER, MILLING, SPOT EDGE MILLING, AND SEAL COAT, STREETS & AVENUES.

SHEET
3 / 3