

SEAL COAT, PATCHING, CONSTRUCTION, AND RECONSTRUCTION DISTRICT #22-41 PHASE 1
 PATCHING, CRACK SEALING, LEVELING, CURB & GUTTER, MILLING, SPOT EDGE MILLING, AND SEAL COAT
 STREETS & AVENUES
 PROJECT AREA
 DISTRICT BOUNDARY
 SCALE: N.T.S.

SEAL COAT, PATCHING, CONSTRUCTION & RECONSTRUCTION DISTRICT #22-41 PHASE I
 PATCHING, CRACK SEALING, LEVELING, CURB & GUTTER, MILLING, SPOT EDGE MILLING, AND SEAL COAT, STREETS & AVENUES,
 SHEET 2 / 3

CITY OF JAMESTOWN
 ENGINEERING DEPARTMENT

DRAWN BY
 JLL
 DATE
 1/5/2022



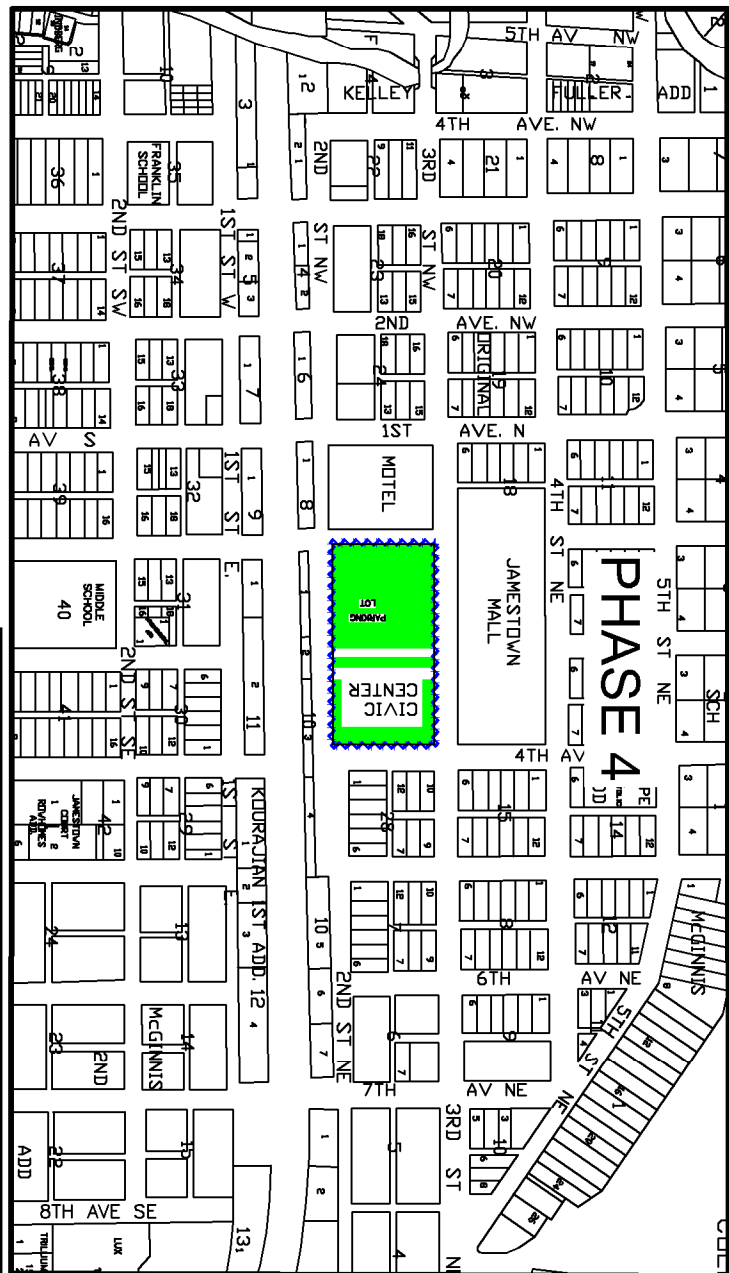
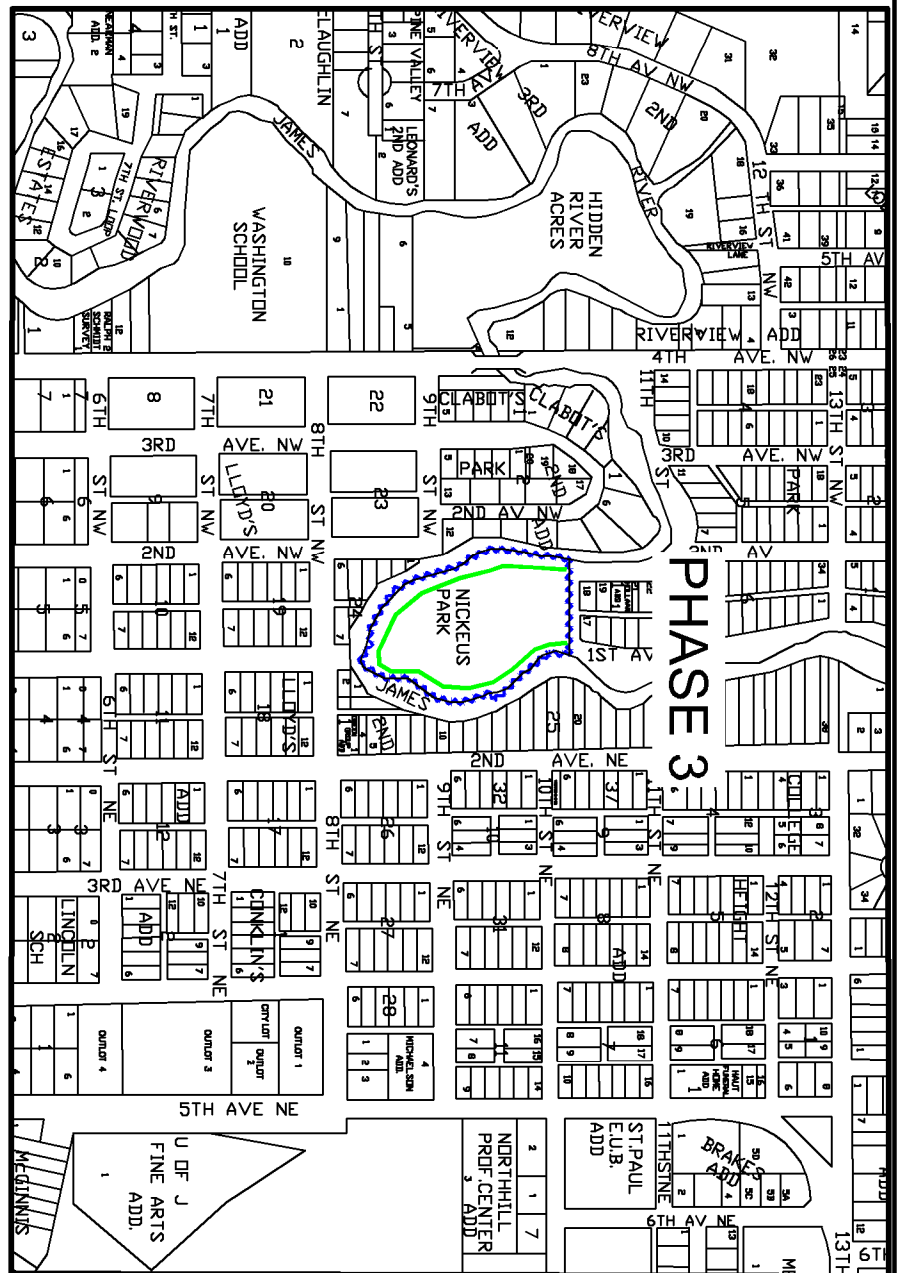
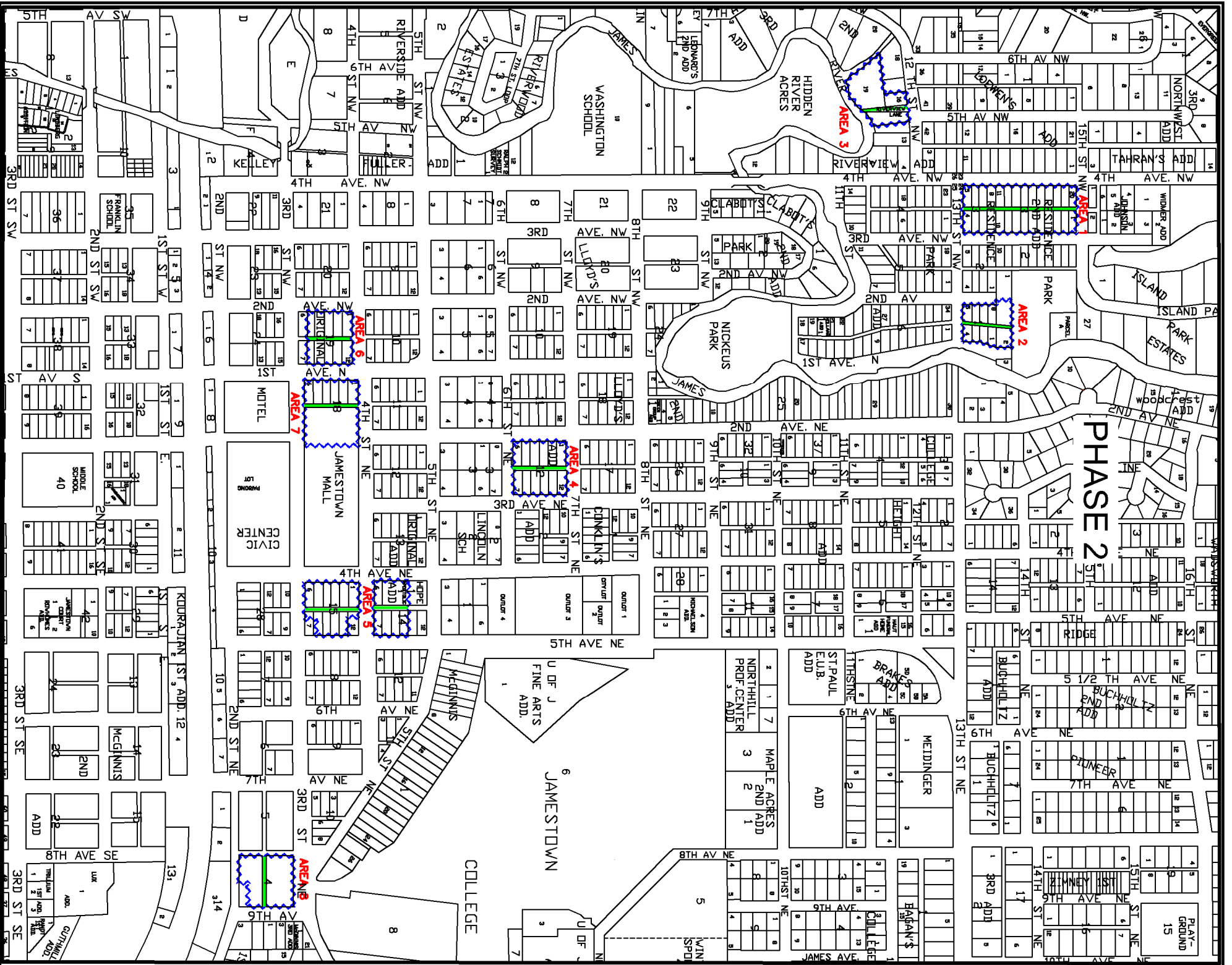

SEAL COAT, PATCHING, CONSTRUCTION, AND RECONSTRUCTION DISTRICT #22-41 PHASE 2, 3, AND 4

PATCHING, CRACK SEALING, LEVELING, AND SEAL COAT

ASPHALT ALLEYS, KLAUS PARK ROAD & LOTS, AND CITY OWNED PARKING LOTS

PROJECT AREA

DISTRICT BOUNDARY

SCALE: N.T.S.

SEAL COAT, PATCHING, CONSTRUCTION & RECONSTRUCTION DISTRICT #22-41 PHASE 1 PATCHING, CRACK SEALING, LEVELING, CURB & GUTTER, MILLING, SPOT EDGE MILLING, AND SEAL COAT, STREETS & AVENUES.

CITY OF JAMESTOWN
ENGINEERING DEPARTMENT

DRAWN BY
JLL
DATE
1/5/2022

